

MECHANICAL TEE - GROOVED

STYLE 35



UL Listed
Under File No. EX15592

- **Housing:** Ductile Iron conforming to ASTM A536, Grade 65-45-12
- **Bolts/Nuts:** Zinc electroplated carbon steel oval neck track head bolts conforming to ASTM A183 Grade 2 and SAE J429 Grade 5 with a minimum tensile strength of 110,000 psi. Zinc electroplated carbon steel heavy hex nut conforming to ASTM A536, Grade A.
- **Coatings:** Rust inhibiting orange paint (Standard) or Hot Dipped Galvanized (Optional) conforming to ASTM A153
- **Gasket Material:** Grade "E" EPDM, Approved and Listed for use in Wet or Dry Systems
- **Gasket Temperature Range:** -40°F to 230°F (Service temperature range)
- **Lubrication:** Supplemental lubricant is recommended for services below 0°F and for all dry pipe systems or systems to be subjected to air tests prior to being filled with water.
- **Sizes:** 2" to 8"
- **Maximum Working Pressure:** 300 psi

Style 35 Mechanical Tee's are bolted saddle type fittings designed for fast installation of bolted branch outlets as an alternative to welding connections. Before installing, please read the Installation Instructions.

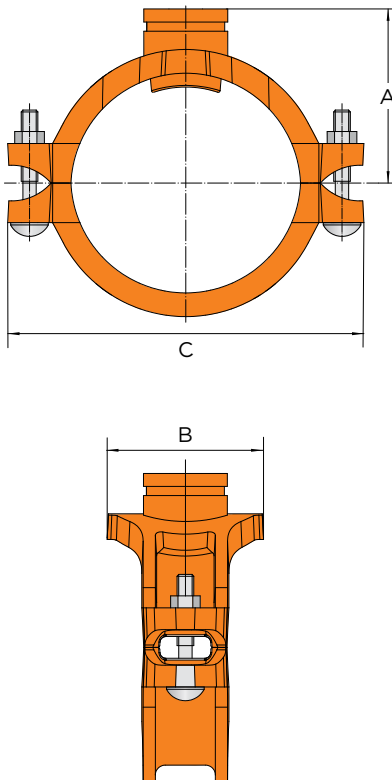

*UL/FM Approvals Pending

MECHANICAL TEE - GROOVED STYLE 35								
Run Size (in.)	Outlet Size (in.)	Max. Working Pressure (psi)*	Hole Diameter (in.)		Grooved Dimensions (in.)			Approx. Weight Each (lb.)
			Hole Saw	Max. Perm.	A	B	C	
2	1-1/4	300	1.75	1.85	2.32	2.72	4.57	1.76
	1-1/2	300	1.75	1.85	2.32	2.72	4.57	1.69
2-1/2	1-1/4	300	2.0	2.06	2.76	3.31	5.67	2.46
	1-1/2	300	2.0	2.13	2.95	3.31	5.67	2.33
	2*	300	2.5	2.63	3.07	3.35	5.35	2.63
3	1-1/4	300	2.0	2.06	2.76	3.23	5.98	2.50
	1-1/2	300	2.0	2.13	2.76	3.58	5.98	2.89
	2	300	2.5	2.63	3.23	3.85	5.98	3.23
4	1-1/4	300	2.0	2.06	3.66	3.27	7.32	3.40
	1-1/2	300	2.0	2.13	3.66	3.27	7.32	3.16
	2	300	2.5	2.63	3.66	3.82	7.40	3.30
	2-1/2	300	2.75	2.88	3.82	4.84	7.40	4.55
5	3	300	3.5	3.55	3.82	4.92	7.40	4.56
	2	300	2.5	2.63	4.21	3.82	8.66	4.47
	3	300	3.5	3.55	4.21	5.35	8.66	6.03
6	1-1/4	300	2.0	2.06	5.04	3.23	9.72	5.50
	1-1/2	300	2.0	2.13	5.04	3.62	9.72	5.55
	2	300	2.5	2.63	5.04	3.86	9.72	6.18
	2-1/2	300	2.75	2.87	5.04	4.84	9.72	5.32
	3	300	3.5	3.55	5.04	5.35	9.72	7.32
8	4	300	4.5	4.63	5.04	6.18	9.72	7.60
	2	300	2.5	2.63	5.98	3.82	12.20	7.50
	2-1/2	300	2.75	2.87	5.98	5.12	12.20	7.92
	3	300	3.5	3.63	5.98	5.40	12.20	8.30
	4	300	4.5	4.63	5.98	6.38	12.20	9.09

PROJECT	APPROVAL STAMP
PROJECT:	<input type="checkbox"/> APPROVED
ADDRESS:	<input type="checkbox"/> APPROVED AS NOTED
ENGINEER:	<input type="checkbox"/> NOT APPROVED
SUBMITTAL DATA:	REMARKS:
NOTES 1:	
NOTES 2:	