

90° ADAPTER ELL STYLE 105TL

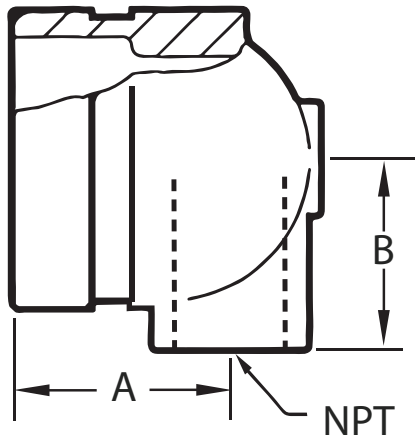

- Transitions from grooved to threaded connection
- Direct connection to sprinkler heads
- Available in rust inhibitive black paint & galvanized finish
- UL/FM rated for 500 psi
- Made of ductile iron conforming to ASTM A536



Nominal Size (In.)	Max. Work Press. (psi)	Dimensions (In.)	
		A	B
1-1/4 x 1/2	500	1.77	1.20
1-1/4 x 3/4	500	1.77	1.20
1-1/4 x 1	500	1.91	1.24
1-1/2 x 1/2	500	1.77	1.32
1-1/2 x 3/4	500	1.77	1.32
1-1/2 x 1	500	1.91	1.32
2 x 1/2	500	1.75	1.57
2 x 3/4	500	1.77	1.57
2 x 1	500	1.91	1.63
2-1/2 x 1/2	500	1.75	1.75
2-1/2 x 3/4	500	1.75	1.75
2-1/2 x 1	500	1.91	1.81

PROJECT	APPROVAL STAMP
PROJECT:	<input type="checkbox"/> APPROVED
ADDRESS:	<input type="checkbox"/> APPROVED AS NOTED
ENGINEER:	<input type="checkbox"/> NOT APPROVED
SUBMITTAL DATA:	REMARKS:
NOTES 1:	
NOTES 2:	